

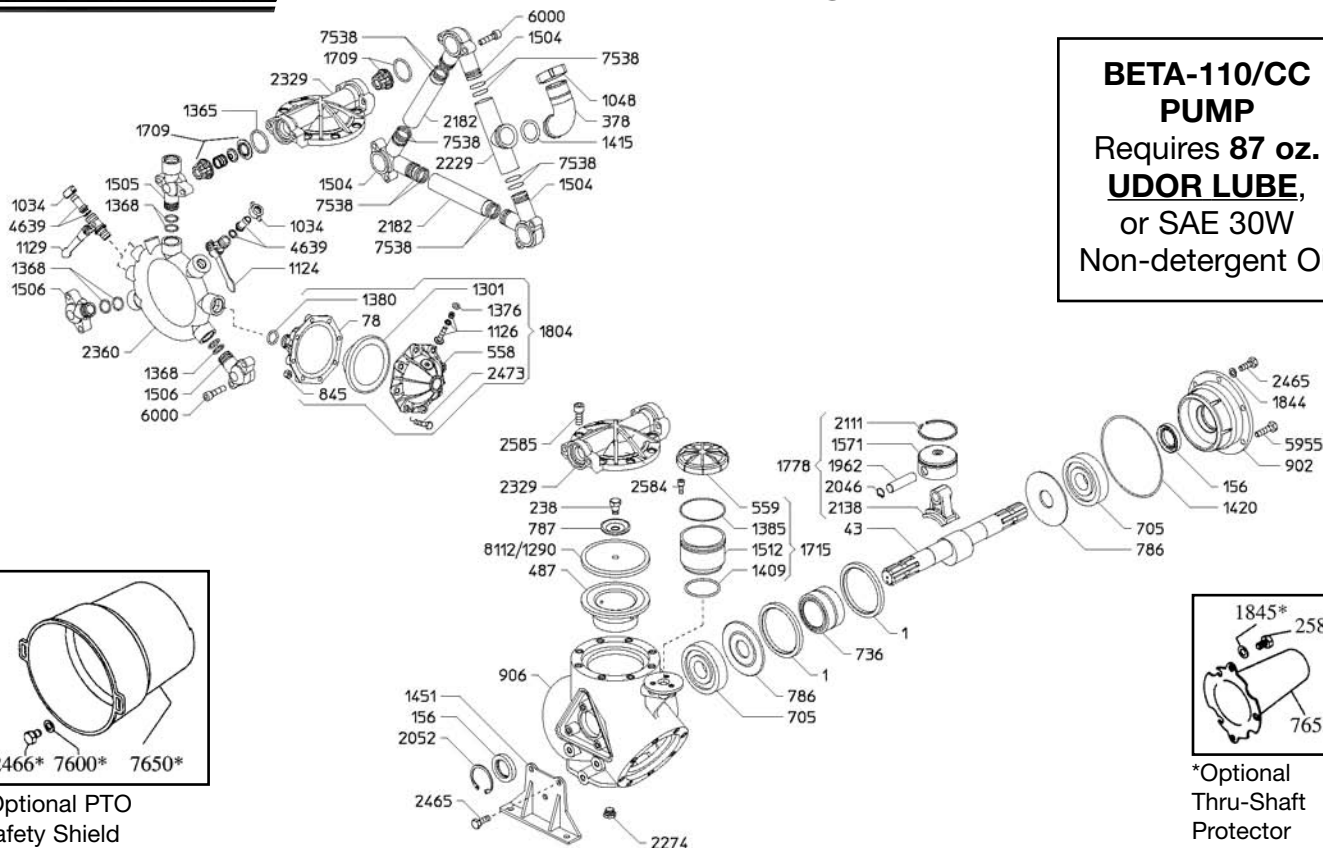

BETA-110/CC

Exploded View Diagram and Parts List



**BETA-110/CC
PUMP**
Requires **87 oz.**
UDOR LUBE,
or SAE 30W
Non-detergent Oil

*Optional PTO
Safety Shield

*Optional
Thru-Shaft
Protector

REF#	PART#	DESCRIPTION	QTY	REF#	PART#	DESCRIPTION	QTY
1	0001.01	retainer ring	2	1506	1203.46	discharge elbow	2
43	0002.29	crankshaft	1	1512	1203.30	oil reservoir	1
78	0003.10	lower accumulator	1	1571	1205.08	piston	3
156	0007.02	shaft seal	2	1709	6006.08	valve assy.	6
238	0102.03	diaphragm bolt	3	1715	6033.02	oil reservoir assy.	1
378	0202.84	suction elbow	1	1778	6015.01	piston/rod assy.	3
487	0206.12	piston sleeve	3	1804	6031.02	accumulator assy.	1
558	0208.21	upper accumulator	1	1844	1403.09	washer	4
559	0208.22	oil cap	1	*1845	1403.10	washer	3
705	0214.11	ball bearing	2	1962	1502.01	wrist pin	3
736	0216.02	needle bearing	1	2046	1506.02	snap ring	6
786	0301.02	spacer	2	2052	1506.16	snap ring	1
787	0301.03	diaphragm washer	3	2111	1509.05	piston ring	3
845	0303.01	nut	8	2138	1519.03	connecting rod	3
902	0501.46	bearing flange	1	2182	1601.11	suction adapter tubes	2
906	0209.16	pump body	1	2229	1602.27	suction tube	1
1034	0604.09	barb nut	2	2274	1603.44	drain plug	1
1048	0604.48	suction nut	1	2329	1604.54	head	3
1124	0608.45	ball valve right	1	2360	1605.21	discharge manifold	1
1126	0608.16	air valve assy.	1	2465	1804.03	bolt	8
1129	0608.46	ball valve left	1	*2466	1804.06	bolt	3
1290	0903.01	piston diaphragm (BUNA) optional	3	2473	1605.31	bolt	8
**1301	0903.16	accumulator diaphragm	1	*2582	1805.04	bolt	3
**1365	1101.01	o-ring	6	2584	1805.06	bolt	3
1368	1101.04	o-ring	6	2585	1805.08	bolt	24
1376	1101.16	o-ring	1	4639	0202.19	discharge barb	2
1380	1101.25	o-ring	1	5955	1804.23	bolt	2
1385	1101.32	o-ring	1	6000	1805.07	bolt	12
1409	1101.68	o-ring	1	7538	1101.34	o-ring	12
1415	1101.77	o-ring	1	*7600	1403.36	washer	3
1420	1101.71	o-ring	1	*7650	1219.02	PTO safety shield optional	1
1451	1202.14	pump rail	2	*7653	1219.15	shaft protector thru shaft optional	1
1504	1203.43	suction elbow	3	**8112	0903.33	piston diaphragm desmopan (STD)	3
1505	1203.45	discharge elbow w/ port	1				

* Parts Included in Diaphragm Repair Kit - #8700.06. (Also available in BUNA-N - #8700.17.)

BETA-110/CC



BETA-110/CC

High Pressure Diaphragm Pump

BETA-110/CC high pressure, high volume diaphragm pumps are excellent for various horticultural and agricultural spraying applications. Simplicity of design and common parts allow easy and affordable maintenance. Control valve, pulsation dampener and pressure gauge are standard.

The BETA-110/CC is constructed of aluminum, brass and stainless steel with brass and stainless steel liquid handling parts.

For industrial uses and spraying applications not listed, please consult UDOR U.S.A. For all PTO drive applications safety shield part #1219.02 is recommended.

Splined Q-2 bushing for pulley drive is available upon request. For thru shaft protection part #1219.15 is recommended.

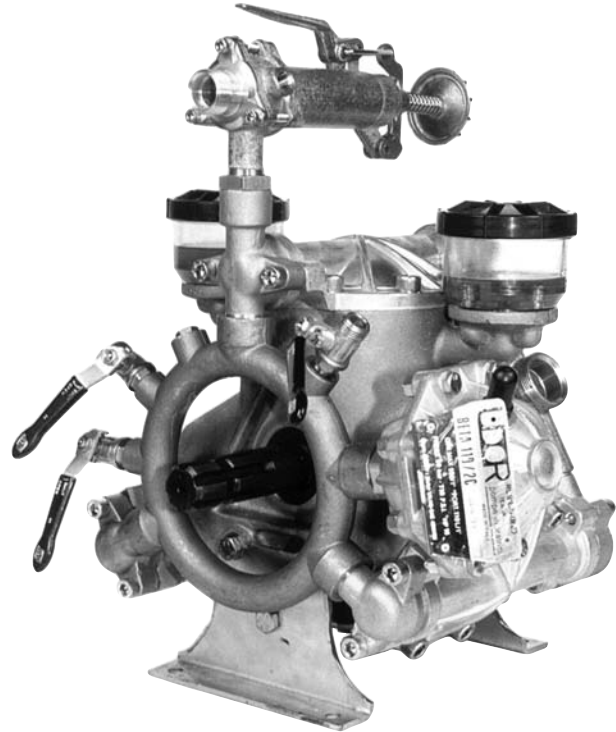

SPECIFICATIONS

Maximum Flow	32 GPM
Maximum Pressure	700 PSI
Maximum Pump Speed	540 RPM
Maximum Temperature	140° F
Inlet Port Hose Barb	1-1/2"
Outlet Ports	
Hose Barb (Ball Valve Controlled)	1/2" (3)
Bypass Hose Barb	1"
Dimensions	L-19.5" x W-15" x H-22"
Weight	105 lbs.
Diaphragm Material	
Standard	DESMOPAN
Optional	BUNA-N

NOTE - Protect pumps from freezing. If freezing conditions exist, flush pump and system with a 50/50 mixture of antifreeze and water.