

CENTRIFUGAL PUMPS

1½" - 2" CAST IRON PUMPS

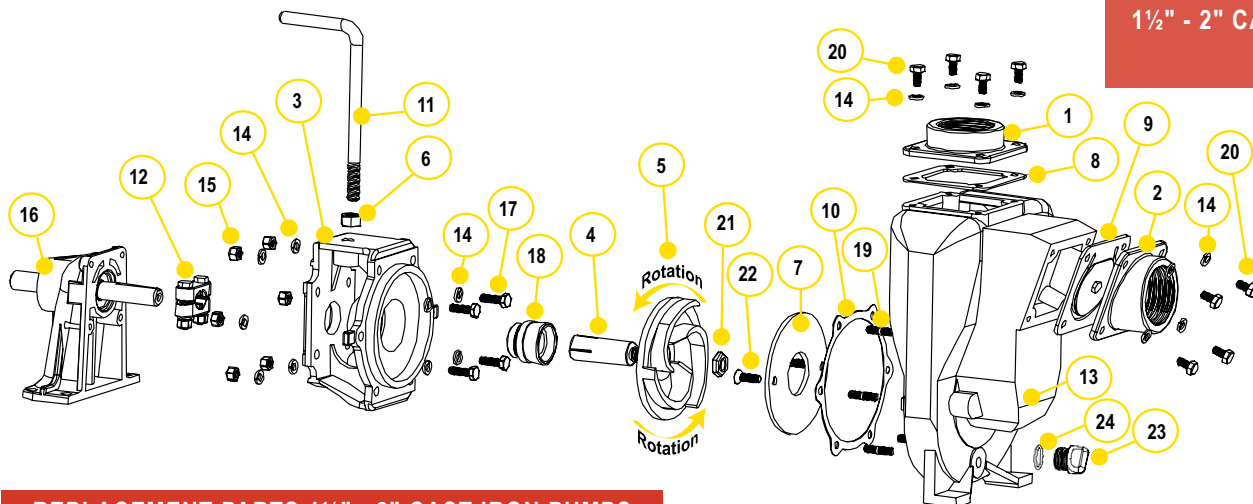

REPLACEMENT PARTS 1½" - 2" CAST IRON PUMPS

ITEM	PART NO	DESCRIPTION	QTY
1	17001	2" NPT OUTLET FLANGE	1
2	17003	2" NPT INLET FLANGE	1
3	17004	ADAPTER FOR GAS ENGINE	1
3	17046	C-FACE ADAPTER	1
4	17005	5/8" SLEEVE DRIVE FOR ELECTRIC MOTOR	1
4*	17006	3/4" SLEEVE DRIVE	1
4	17007	7/8" SLEEVE DRIVE FOR ELECTRIC MOTOR	1
5*	17008	5" IMPELLER	1
5	17008-4.6	4.6" TRIMMED IMPELLER	1
5	17008-4.1	4.1" TRIMMED IMPELLER	1
6	17010	1/2" HEX NUT	1
7*	17011	WEAR PLATE	1
8	17013	EPDM GASKET	1
9	17016	CHECK VALVE ASSEMBLY	1
10*	17018	GASKET ADAPTER	1
11	15022	HANDLE	1
12	17023	5/8" CLAMP FOR 3/4" SHAFT ASSEMBLY (OLD STYLE)	1
12	17123	5/8" CLAMP FOR 3/4" SHAFT ASSEMBLY (KEYED)	1
12	17024	7/8" CLAMP FOR SHAFT ASSEMBLY	1
13	17026	PUMP HOUSING	1
14	V10118	5/16" LOCK WASHER	18
15	V10119	5/16" - 18 SS HEX NUT	6
N/S	12884	INTERNAL RETAINING CLIP FOR PEDESTAL	1
N/S	12883B	BEARINGS	2
16	12882A	COMPLETE PEDESTAL ASSEMBLY	1
17	17040	5/16" -24 X 1.00" CAP SCREW	4
18	17028	EPDM SEAL ASSEMBLY	1
18*	17035	FKM SEAL ASSEMBLY	1
18	17035SD	SEVERE DUTY SEAL	1
19	17042	STUD	6
20	17019	5/16"-18 X 3/4" CAP SCREW	8
21	17009B	5/8" IMPELLER NUT	1
22	17130	5/16-18 X 1.00" FHSCS, 18-8 SS	2
23	12777	1/2" PLUG	1
24	UV15163	O-RING	1
N/S	17033	Z RAILS (PAIR)	1
N/S	17100	REPAIR KIT (CONSISTS OF ITEMS 4*, 5*, 7,10,18*)	1

